

**SHEET NOTES**

1. FIELD VERIFY ALL SITE CONDITIONS BEFORE STARTING CONSTRUCTION.
2. ALL EXISTING DUCTWORK, PIPING, EQUIPMENT, ETC. INDICATED ON PLANS ARE BASED ON INFORMATION FROM CONSTRUCTION DOCUMENTS AND FIELD VERIFICATION OF EXISTING BUILDING.
3. COORDINATE INSTALLATION OF ALL NEW DUCTWORK, PIPING, EQUIPMENT, ETC. WITH OTHER TRADES.

**KEYNOTE LEGEND**

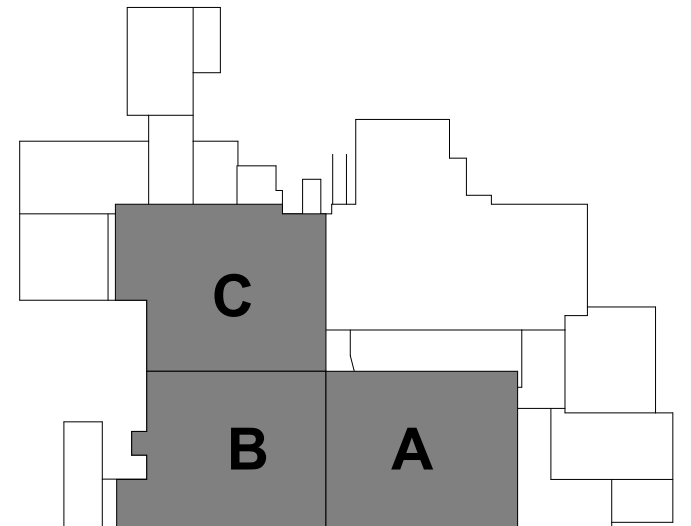

KEY PLAN

I HEREBY CERTIFY THAT THIS PLAN, SPECIFICATION OR REPORT WAS PREPARED BY ME OR UNDER MY DIRECT SUPERVISION AND THAT I AM A DULY LICENSED PROFESSIONAL ENGINEER UNDER THE LAWS OF THE STATE OF MINNESOTA.

ANTHONY J. EFFENBERGER

*Anthony J. Effenberger*  
 DATE 4/1 LIC. NO. 41935

I HEREBY CERTIFY THAT THIS PLAN, SPECIFICATION OR REPORT WAS PREPARED BY ME OR UNDER MY DIRECT SUPERVISION AND THAT I AM A DULY LICENSED ARCHITECT UNDER THE LAWS OF THE STATE OF MINNESOTA.

DATE LIC. NO.

THIS DOCUMENT IS THE PROPERTY OF I & S GROUP, INC. AND MAY NOT BE USED, COPIED OR DUPLICATED WITHOUT PRIOR WRITTEN CONSENT.

PROJECT

**PILGRIM'S PRIDE  
 PROCESS PIPING**

COLD SPRING MINNESOTA

REVISION SCHEDULE		
DATE	DESCRIPTION	BY

PROJECT NO. 20-24496  
 FILE NAME 24496 Mech R20.rvt  
 DRAWN BY CHP  
 DESIGNED BY CHP  
 REVIEWED BY AJE  
 ORIGINAL ISSUE DATE 01/04/21  
 CLIENT PROJECT NO.

TITLE  
**OVERALL  
 PROCESS PIPING  
 PLAN**

SHEET  
**P2-31**

1 OVERALL PROCESS PIPING PLAN  
 1/16" = 1'-0"

